

NOTE
 This drawing is to read in conjunction with all other Architects drawings and all Structural Engineers drawings details and calculations.
 It is the contractors responsibility to check all dimensions prior to fabrication or construction, any discrepancies to be reported to the Architect.

KEY TO SURFACE FINISHES

-  PORAFLEX HIGH PERFORMANCE WATER PERMEABLE ACRYLIC TENNIS SURFACE IN TWO SHADES OF GREEN
-  GREEN TIGER TURF TO MATCH COURTS ON HIGHER LEVEL
-  OLTCO RESIN TO PATIO AND AREAS AROUND CLUBHOUSE. LAID ON MACADAM BASE AS COURTS AREA.

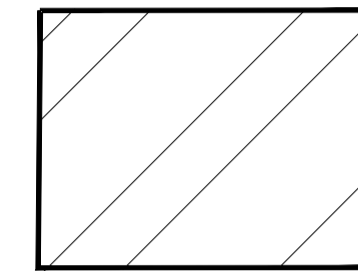
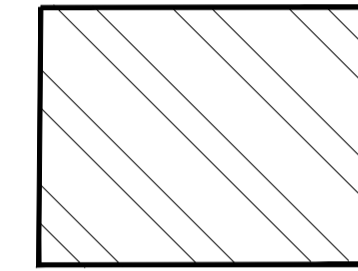
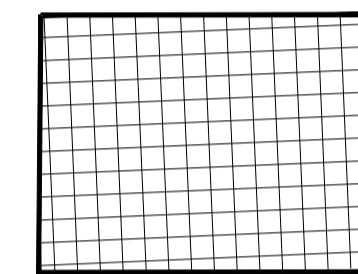
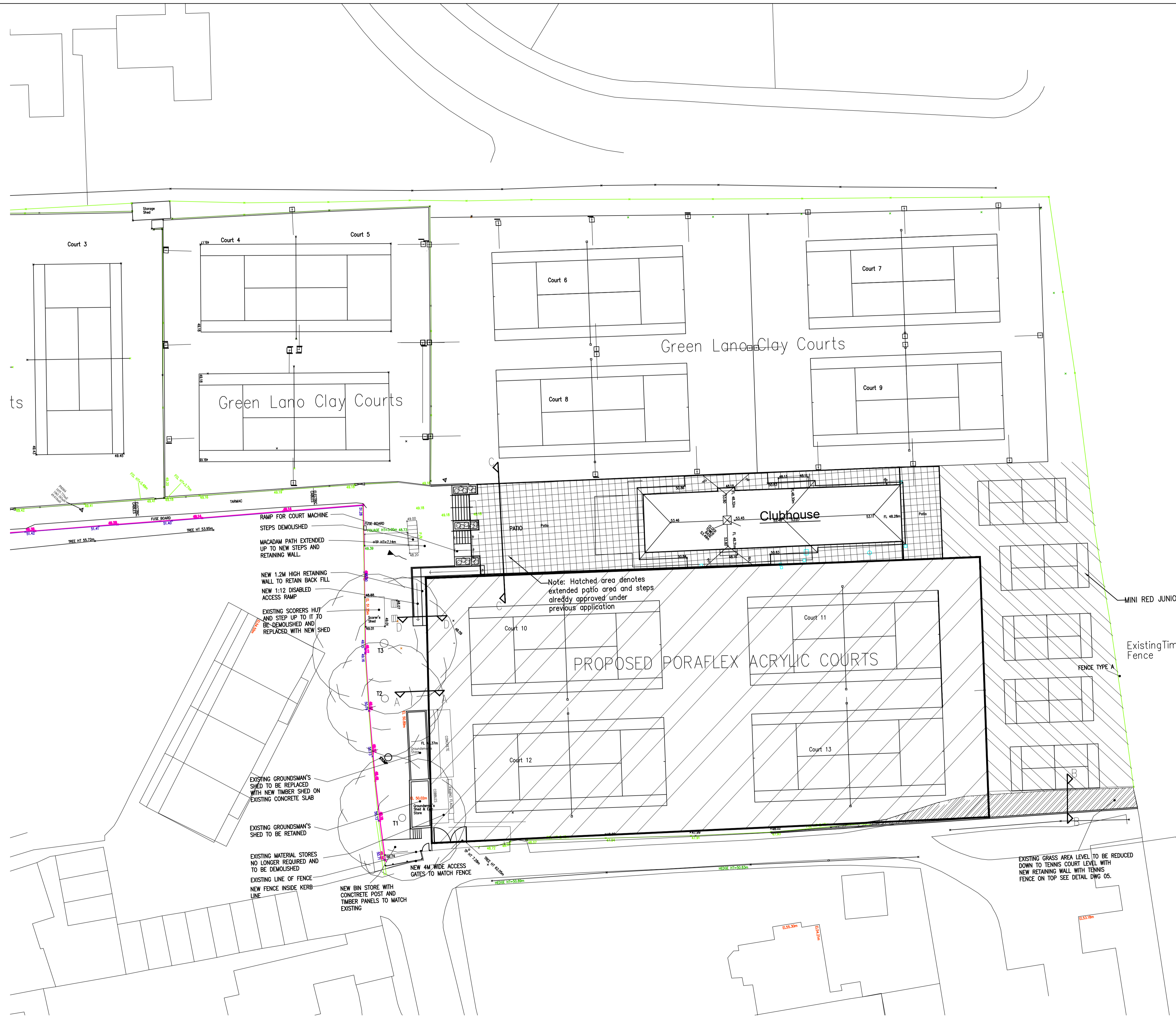

- Revisions:**
- Rev A: Amended wall finish to store 10.09.20
 - Rev B: Amended extent of resin/added 2 tier planters 15.10.20
 - Rev C: Added scale bar & DDA ramp 22.10.20
 - Rev D: Added store back on existing slab 09.11.20

KIRKMAN
 ARCHITECTS

PO Box 929
 ALTRINCHAM, CHESHIRE
 WA15 5QL
 TEL: 07974 254060
 WWW.KIRKMANARCHITECTS.CO.UK

Project BOWDON LAWN TENNIS CLUB ELCHO ROAD BOWDON		
Drawing PROPOSED PLAN		
Date OCT 2020	Drawn By DBK	Scale 1:500
Drawing Status PLANNING	Drawing No. 1453-02	Rev No. D

Proposed Plan

Scale 1:200

Scale Bar

