

Dunkeld & Birnam Sports and Leisure Hub

Proposed MUGA (Multi Use Games Area) : Q&A

Issue 1 - July 2020

1. Introduction

This is a follow up to specific comments and questions received on the MUGA proposal issued in June 2020.

2. Follow up commentary

Q1 How does the covered MUGA affect the daylight etc over principally the tennis courts but also bowling green due to its proximity. Would it cast a shadow affecting the amenity and surface of the tennis court?

Response – we have undertaken a desktop daylight study to better understand this. Appended to this response are a series of studies taken at mid-summer, mid-February and mid-October. In summary, the MUGA has very little negative impact on the shading of the tennis courts. The main shading influence over the tennis courts remains the perimeter trees. The bowling green shading is unaffected by the MUGA. As with the tennis courts the perimeter trees to the bowling green are the main shading influence.

Q2 The construction may significantly affect the access and use of other facilities. How would this be managed?

Response – to enable the construction to commence the alternative car park would need to be in place. The existing car park area would be cordoned off with a designated safe pedestrian route along the side of the burn to the clubhouse and other facilities. The MUGA court and fencing works would be similar in the type of work and equipment on site to the recent tennis court upgrade works, with similar minimal impact on the usage of the adjacent areas. The MUGA roof would consist of off-site fabricated steelwork with small scale craneage required on site for a short period during the assembly and fabric cover installation.

Q3 How would, say football on the MUGA affect the other sports, especially if this was open rather than covered. This again relates to the proximity aspect.

Response – Mesh screening similar to that on the tennis courts would help cut down any visual distraction between the tennis courts and MUGA activities. Noise from any sports or activities would be audible, however the MUGA would be set back by at least 3m from the tennis court fencing so the present noise impact of the basketball hoop would be slightly improved. A MUGA roof would assist in further reducing any impact of noise.

Q4 Has there been an assessment of the car parking requirements?

Response – the existing car park is an irregular shape which tends not to lend itself to a particularly efficient parking configuration, which at times creates issues. If the existing car park was lined out with parking bays we estimate it would accommodate approximately 26 cars. This would increase to approximately 32 spaces if double parking were adopted. The geometry of the alternative car parking lends itself to a more linear solution which is more efficient allowing double sided parking off a single access road. This could accommodate up to 35 cars. In addition there will be sufficient space on the site of the existing car park to accommodate 3 accessible spaces plus bike racks. The overall position is an additional 12 car spaces.

Q5 Do we have a sense of which sports would mostly use the MUGA?

Response – Through this consultation we are looking for feedback on what particular interest there is in which sports and activities. There has been strong interest from the football, netball and tennis communities so far.

Q6 I have read with interest the proposal for a covered multi-use-games-area, MUGA. I think this will be of great value to the community, especially for the younger people. However, my concern is the approach road - the lane running up past the medical practice. This lane, having no pavements, is used not only for those people going to the medical practice, but also by the many local dog owners and walkers. The provision of the MUGA will inevitably mean that there will be increased use of this lane. I think it is absolutely imperative that a speed restriction is imposed along the lane, for a maximum speed of 15mph. Even now, there are many cars going either to the recreation ground, medical practice, etc. that travel at speeds well in excess, causing concern to those walking along the lane and many of us feel that a speed restriction should indeed have been imposed long ago.

Response – we are in complete agreement that the lane requires improvement to make it safer for pedestrians to the medical centre, the Sports Hub and also the footpath link to Inver. Regardless of the MUGA proceeding or not the Sports Hub intend taking this matter up with the local authorities.

Dunkeld and Birnam Sports and Leisure Hub

Attachments:

1. Daylight study

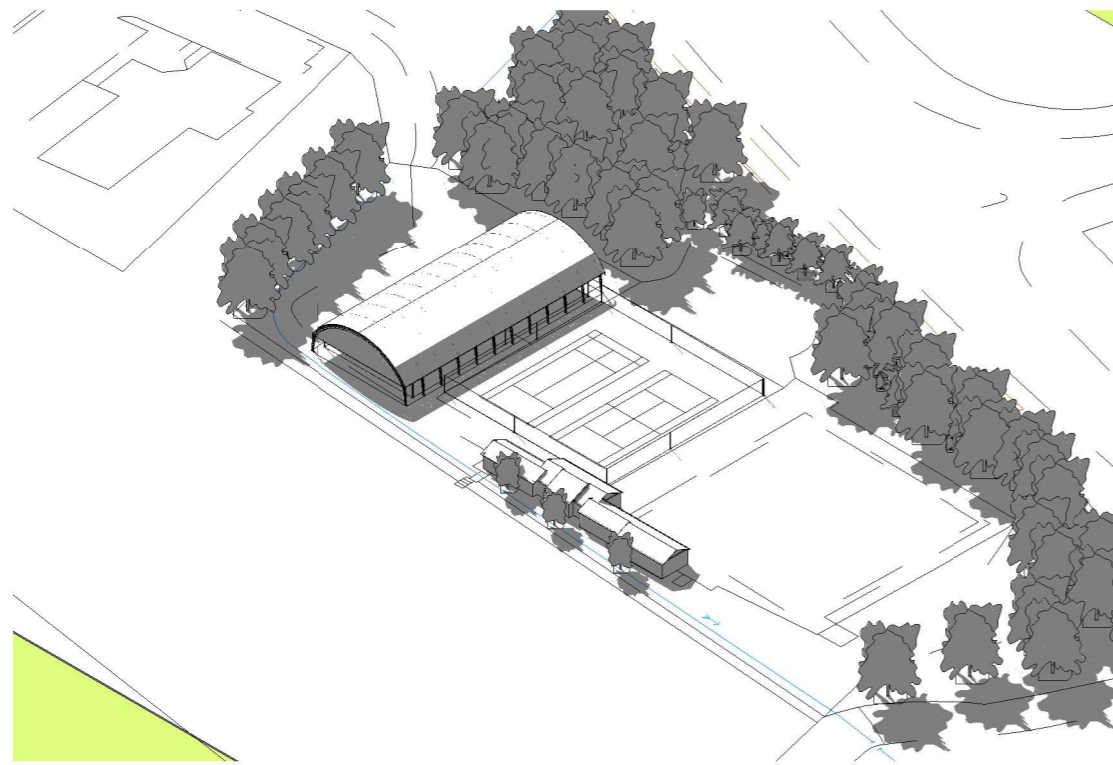

1 Summer Solstice_ 9am

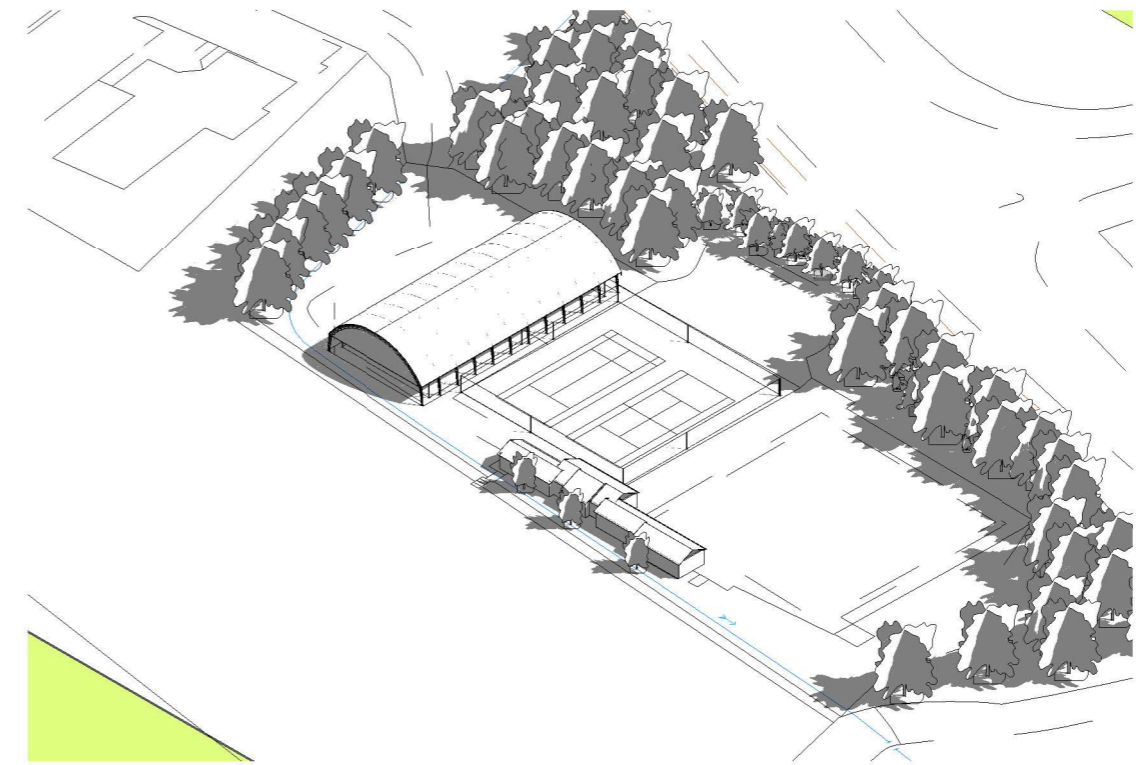

2 Summer Solstice_ Midday

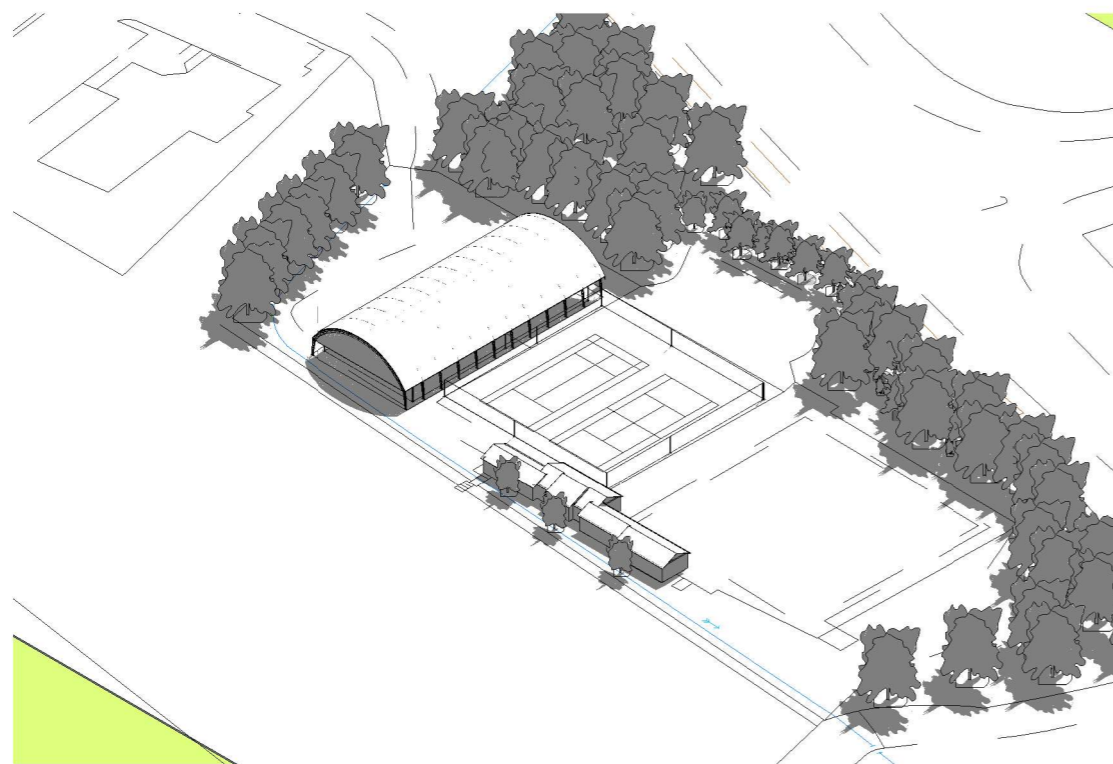

3 Summer Solstice_ 3pm

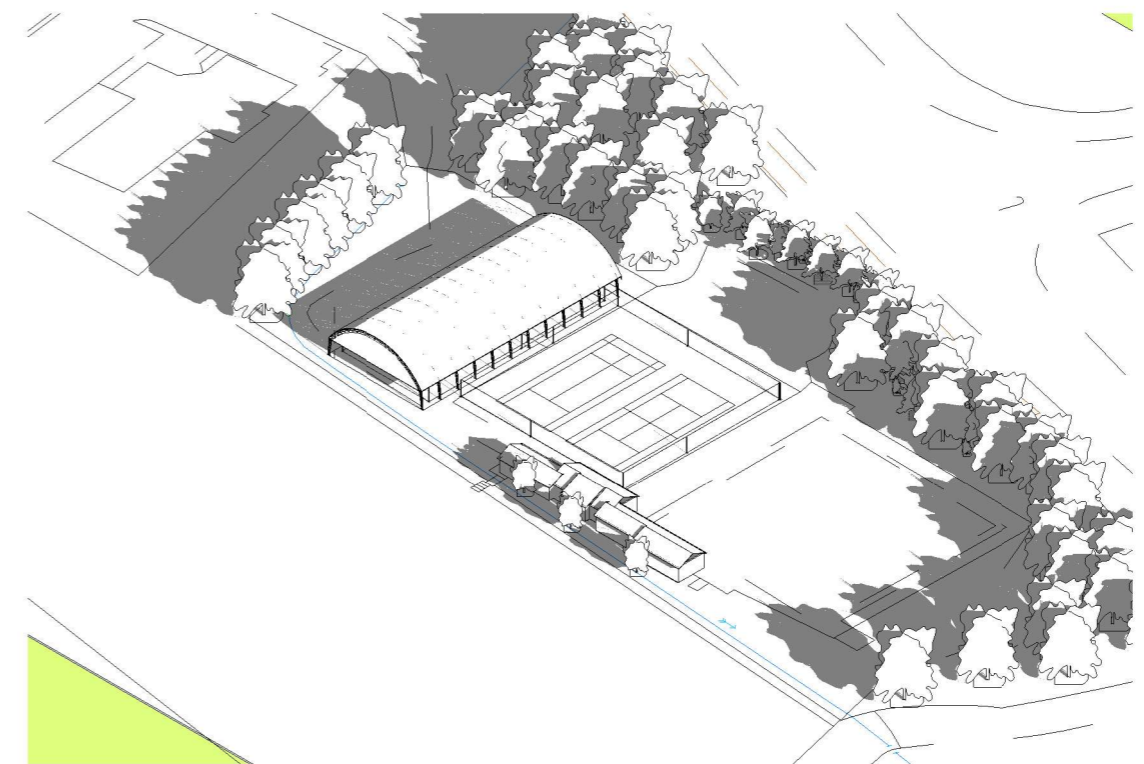

4 Summer Solstice_ 6pm

Revision	Drawn	Checked	Date

UR
 URBAN RURAL
 DESIGN STUDIO

Client
 Dunkeld and Birnam Sports and
 Leisure Club

Project
 Proposed MUGA

Drawn
 Summer Solstice
 Daylight Model

Project No.
 2020_MUGA

Drawing No.
 SK_90_500

Status

Created	Author	Checked	Checker
Date	07/07/20	Scale	@A1

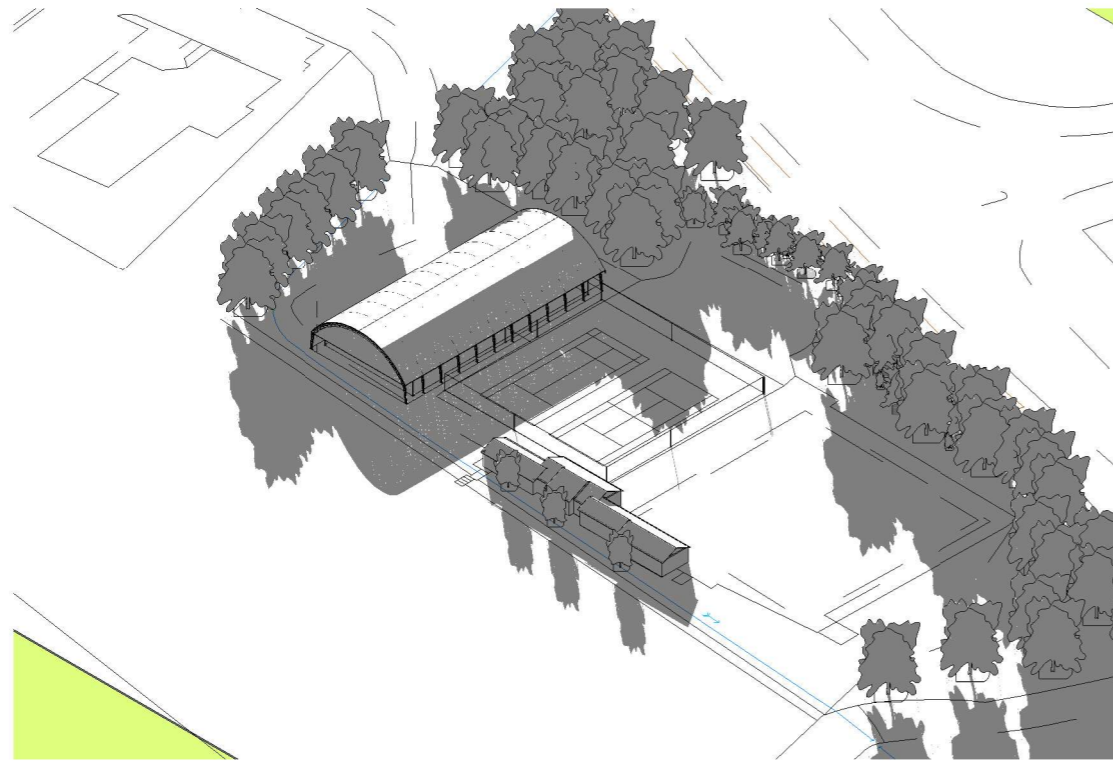

1 Mid October_9am

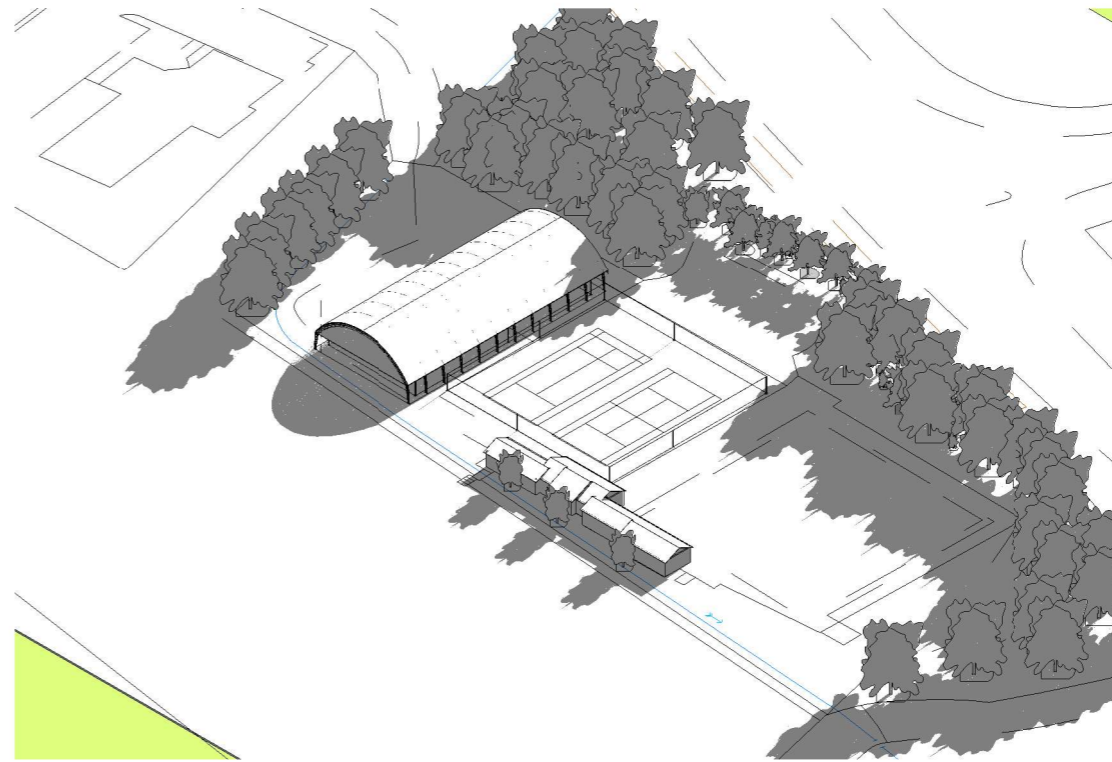

2 Mid October_Midday

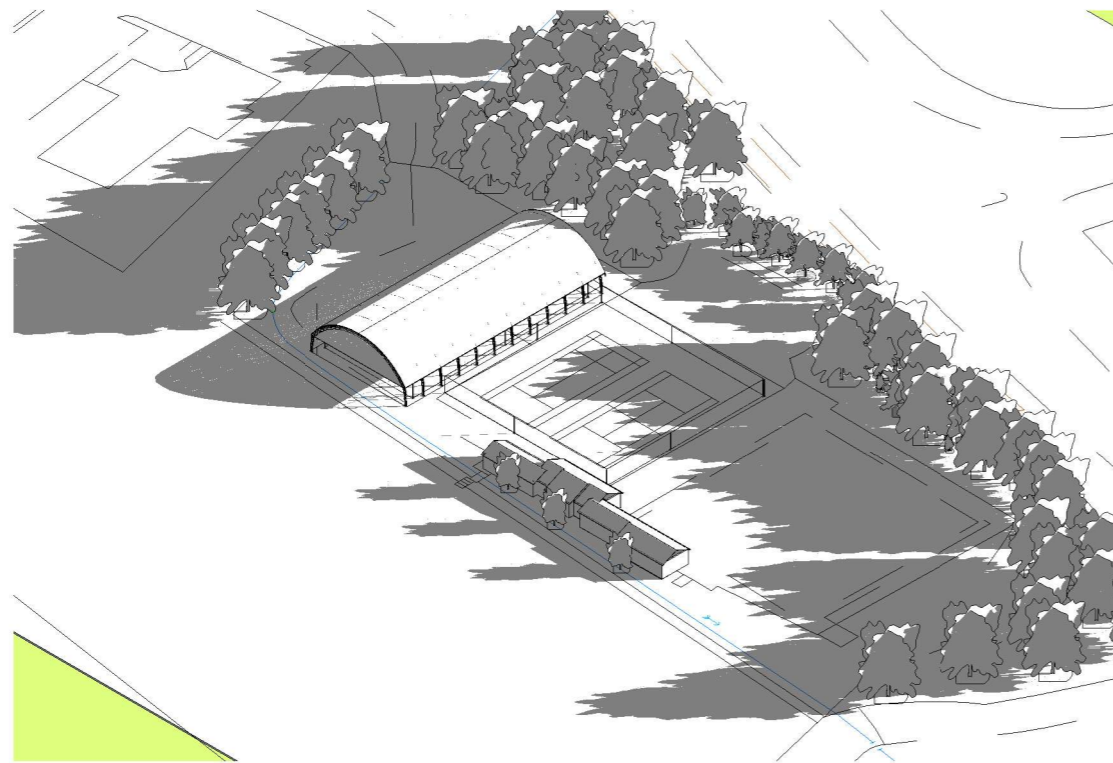

3 Mid October_3pm

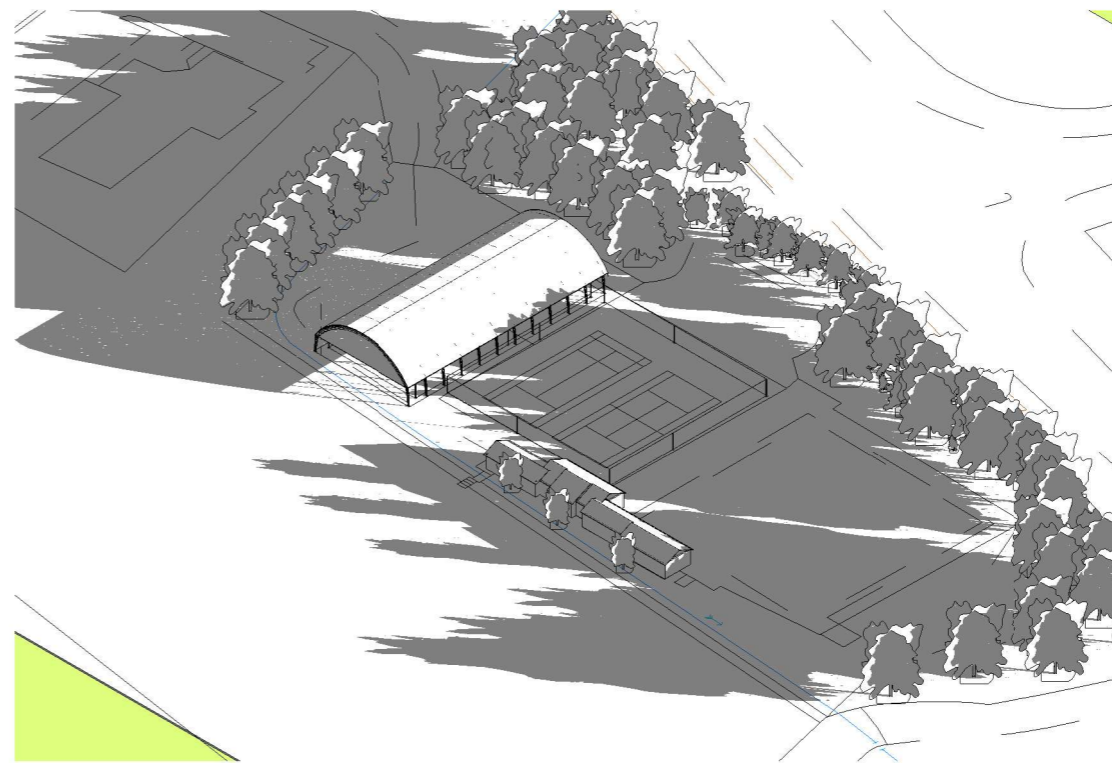

4 Mid October_6pm

Revision	Drawn	Chk'd	Date

UR
 URBAN RURAL
 DESIGN STUDIO

Client
 Dunkeld and Birnam Sports and
 Leisure Club

Project
 Proposed MUGA

Drawn
 Mid October
 Daylight Model

Project No.
 2020_MUGA

Drawing No.
 SK_90_502

Status

Created	Author	Checked	Checker
Date	07/11/20	Scale	@A1

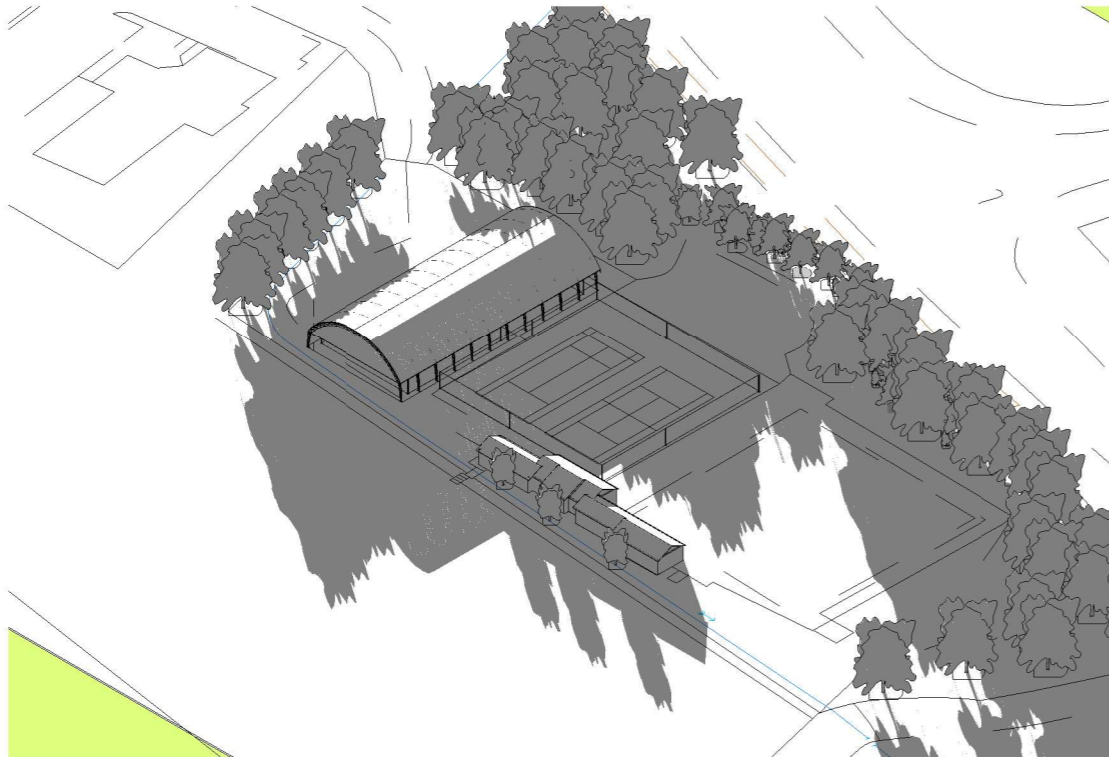

1 Mid Feb_ 9am

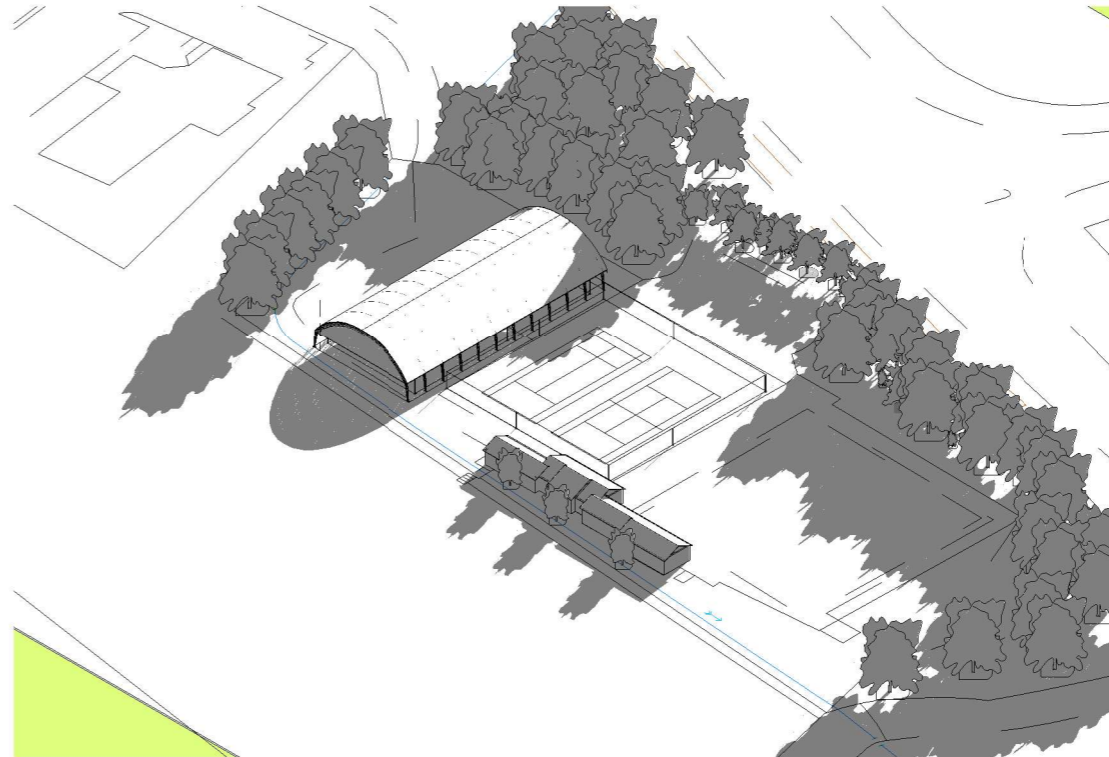

2 Mid Feb_ Midday

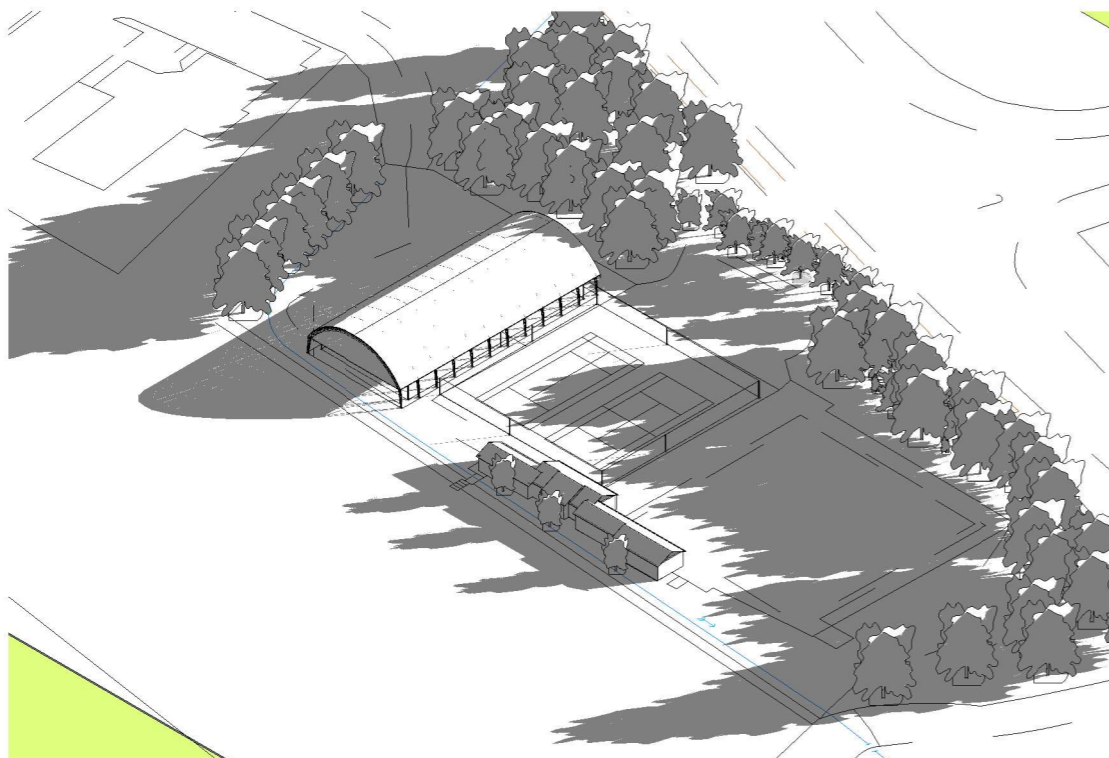

3 Mid Feb_ 3pm

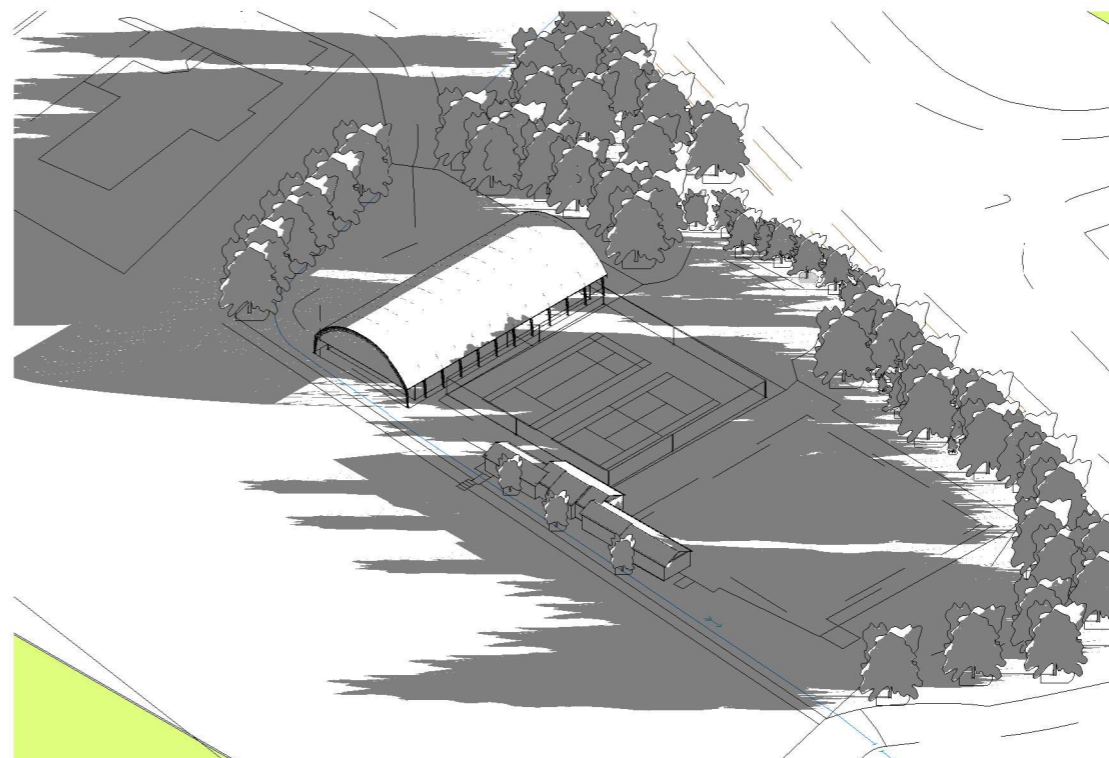

4 Mid Feb_ 6pm

Revision	Drawn	Checked	Date

UR
 URBAN RURAL
 DESIGN STUDIO
 Client
 Dunkeld and Birnam Sports and
 Leisure Club
 Project
 Proposed MUGA
 Drawn
 Mid February
 Daylight Model
 Project No.
 2020_MUGA
 Drawing No.
 SK_90_501
 Status

Created	Author	Checked	Checker
Date	07/11/20	Scale	@A1